

STEEL PLY®



VERTICAL FORMING SYSTEMS

Steel-Ply® Features

Steel-Ply® is today's superior form. The reinforced, high-carbon steel frame means edges stay straight and corners stay square, so panels are quickly aligned and easily stacked. Built-in handles make moving and placing the panels easy, too.

The long-lasting plywood facing have a heavy-duty overlay and aluminum-filled polyurethane edge sealer to keep out moisture and prevent delamination and swelling. When needed, refacing is simple and inexpensive.

All these factors combine to create a 1,000 psf rated system that will save you time in setup, last longer and give you better results.

Panels and Fillers

There are 80 sizes available for fast erection of virtually any layout by combining panel and filler sizes and erecting vertically or horizontally. This eliminates the sawing, drilling, measuring and nailing common with job-built forming. Quick and easy handling, no tops, bottoms, lefts or rights makes for improved labor productivity.

Steel-Ply® owners commonly report 200 to 300 reuses from panels and filler before re-ply is necessary.

Special 1/2" HDO Plywood is edge-and surface-sealed to prevent deterioration and to prolong form life.

Durable, high carbon steel frames are reinforced for rigidity and strength to surround and protect the plywood.

No measuring or drilling for ties-dado slots are placed 12" on center and 6" from each end for tie insertion.

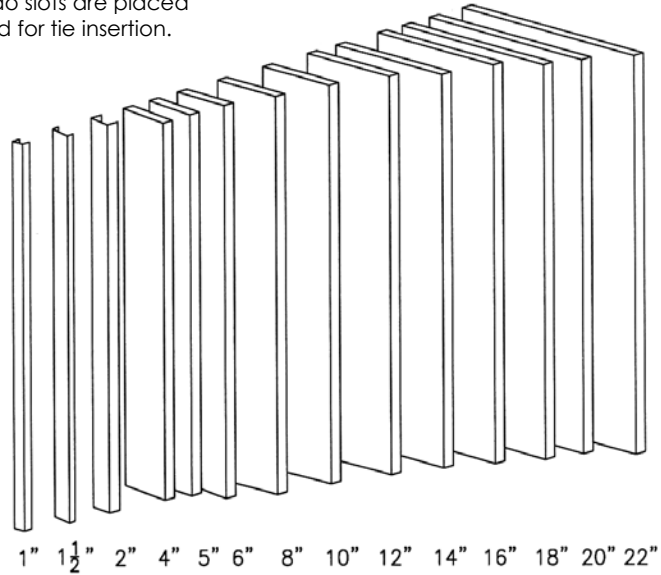
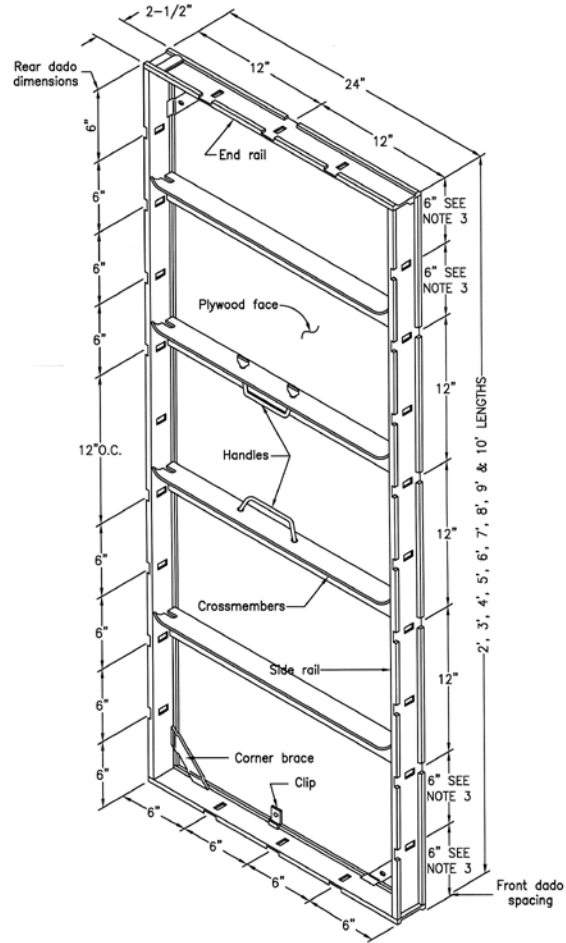

STEEL PLY®

VERTICAL FORMING SYSTEMS

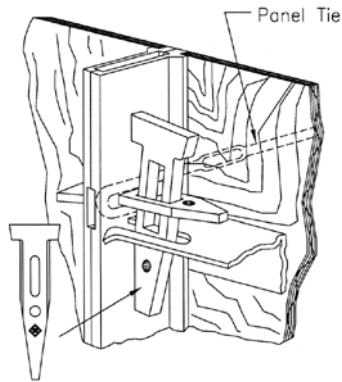

Wedge Bolt connections enable unskilled laborers to become consistently productive. No special tools are required, just a hammer. Wedge Bolts connect panels and capture ties at the same time.

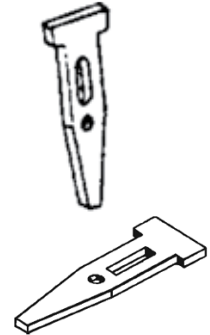

**WEDGE BOLTS
SY 60058**

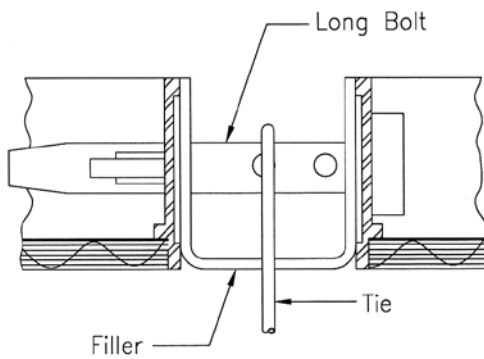

The **Long Bolt** similar to the Wedge Bolt, is used to connect the 1", 1½" and 2" steel filler to adjust panels and filler.

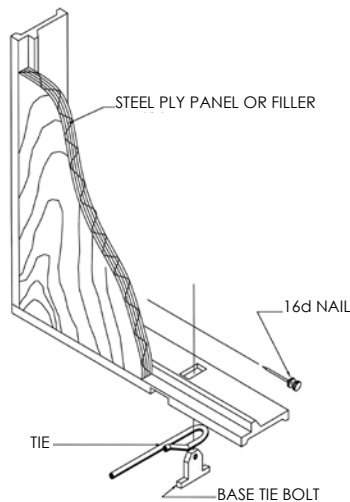
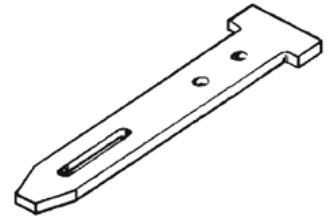

With a shorter length and slot than a Wedge Bolt, the **Short Bolt** can be used to attach the pilaster form to a Steel-Ply form.



**SHORT BOLTS
SY 60049**

SY 60087

The **Base Tie Bolt** secures either a panel tie or a flat tie to an end rail or a side rail (1) when resting on a footing, or (2) where panels butt against existing vertical surface.

STEEL PLY®



VERTICAL FORMING SYSTEMS

Waler Attachment

Standard 2" x 4" or 2" x 6" lumber can be used as walers for the Steel-Ply® Forming System. With specially designed hardware, the walers are quickly fastened to bring form work into alignment. Only one row of walers is required per tier of forms for handset applications.

Strongback Attachment

Additional tiers of forms will require strongbacks for vertical alignment of the form work. Strongbacks are required only on one side of the forms for handset hardware to make stacking easy.

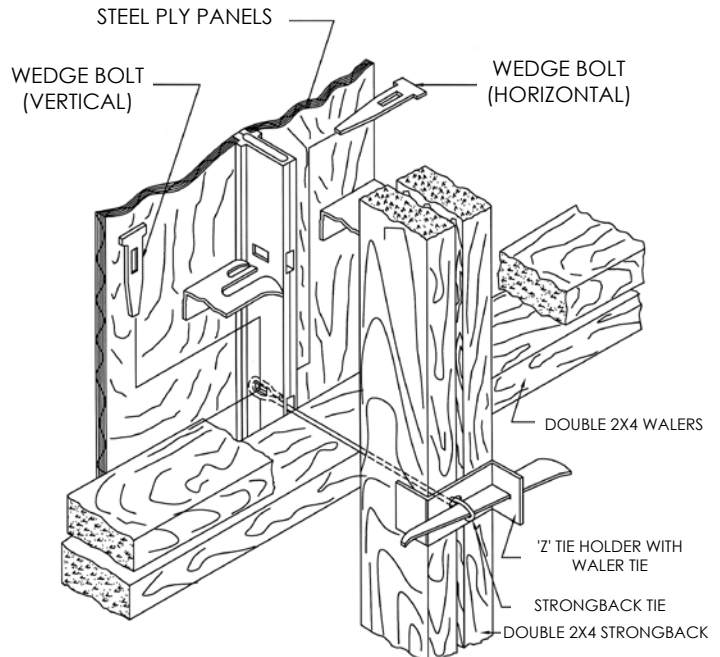
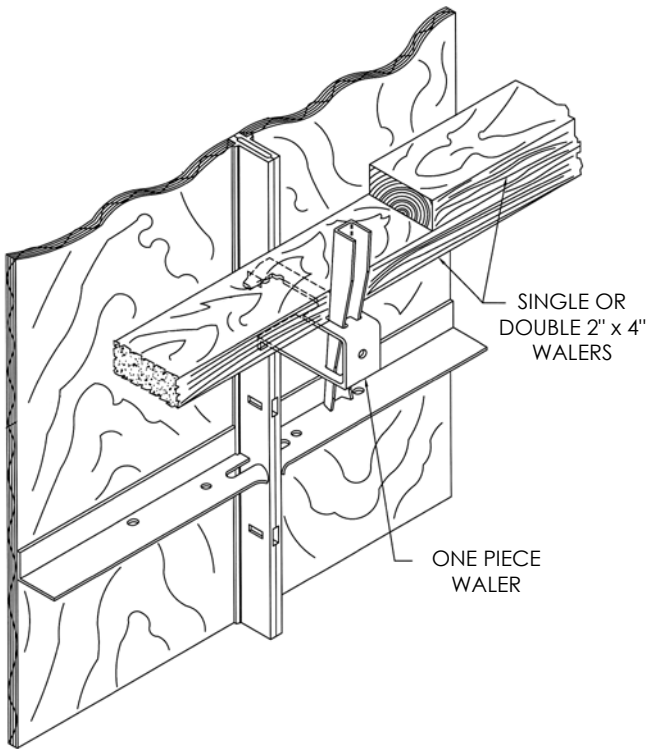

Job Built Filler

Filling Angles provide a means to construct a custom size filler of 3/4" plywood that can be connected to side rails of adjoining forms.

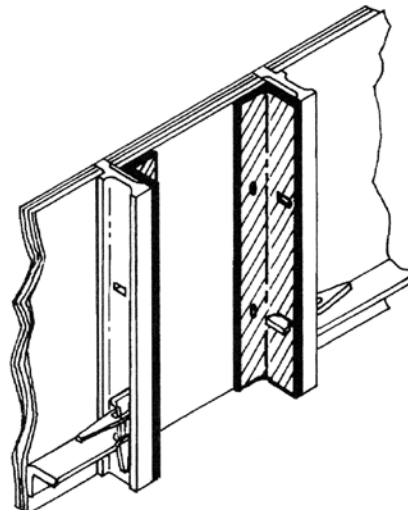

STEEL PLY®

VERTICAL FORMING SYSTEMS

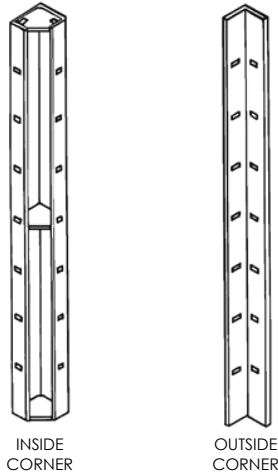

Inside and Outside Corners
Reusable steel corners, built to precise tolerances, minimize errors by eliminating measures, sawing and fitting. Both Inside and Outside Corners are available in five lengths and can be set with either end up or down to reduce the time and labor required.

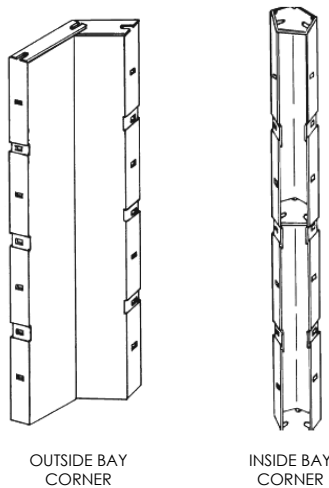
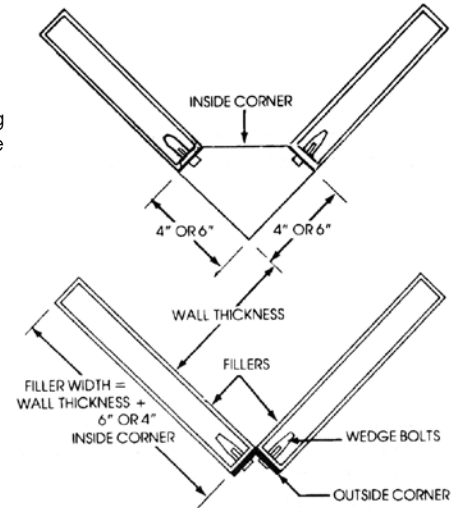

Bay Corners
Standard 135 Inside and Outside Bay Corners simplify forming. Attach them to Steel-Ply® panels and fillers with Wedge Bolts for quick and easy assembly. Inside and Outside Bay Corners are available in five standard lengths.

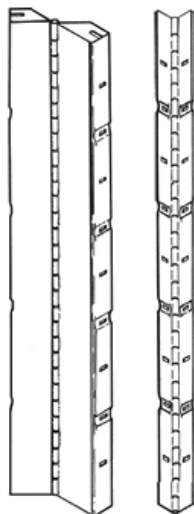
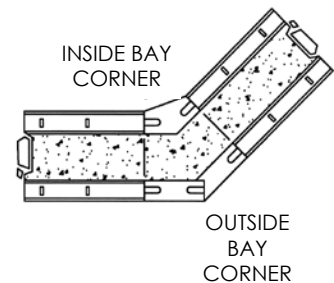

Hinged Corners
In most wall applications, Inside Hinged Corners are used opposite Outside Hinged Corners to achieve the desired angle. The Inside Hinged Corner may be used to form inside corners as narrow as 45°. The Outside Hinged Corner will form outside corners from 5° to 135°. Filler sizes needed to make up dimensions will vary depending on the angle being formed.

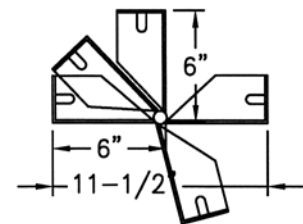

STEEL PLY®



VERTICAL FORMING SYSTEMS

Scaffold Bracket

The Steel-Ply® Scaffold Bracket assembly provides a safe access platform for above-grade applications. The Scaffold Bracket is quickly attached to form work with a Wedge Bolt and the attached S-Wedge. Scaffold planking, toe boards and guard rails (by contractor) complete the work platform.

Note: Do not use the Scaffold Bracket to support concrete soffit forms or for temporary storage of equipment and materials.

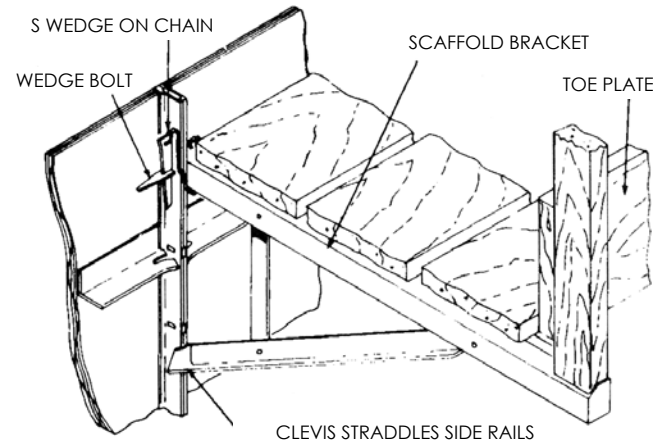

Pilaster Forms

Pilaster of less than 12 inches are formed quickly and easily using the Steel-Ply® Forming System and Pilaster Forms. The Pilaster Form eliminates the need for using inside and outside corners with specific filler sizes. Pilaster Forms can be used to form concrete pilasters from 1 to 12 inches deep in 1 inch increments.

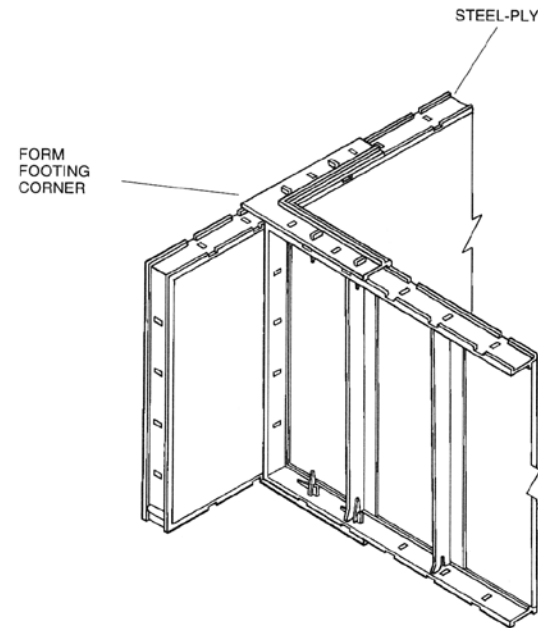
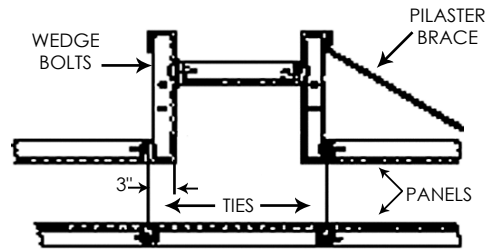

Footing Corner Bracket

Footing, pad and slab forming with Steel-Ply is made easy with the Footing Corner Bracket and the Stake Plate. Two Footing Corner Brackets at each corner, one on top and one on the bottom hold the panels firmly, and at virtually any dimension that your job requires (2" increments). The Stake Plates are then positioned along the top edge of the Steel-Ply panels as needed for steel stakes to hold the forms in place against the concrete pressure. Either 3/4" round or I-beam steel stakes can be used with the Stake Plate. The Stake Plates can be located midway between Steel-Ply crossmembers and end rails to provide access for a stake puller.

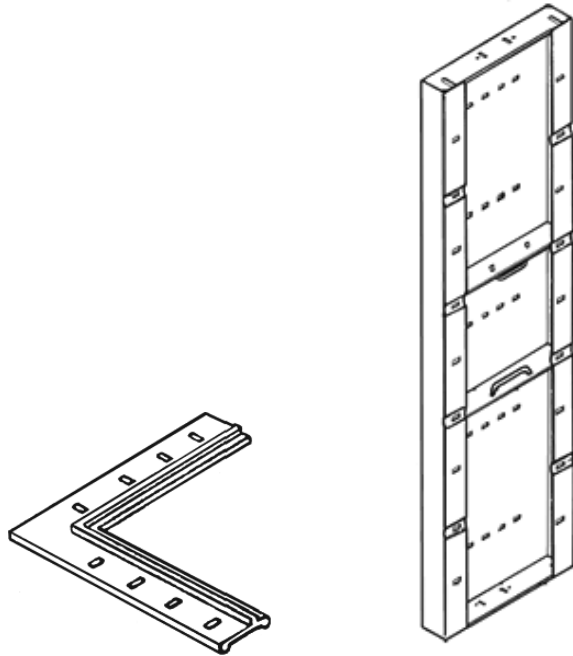

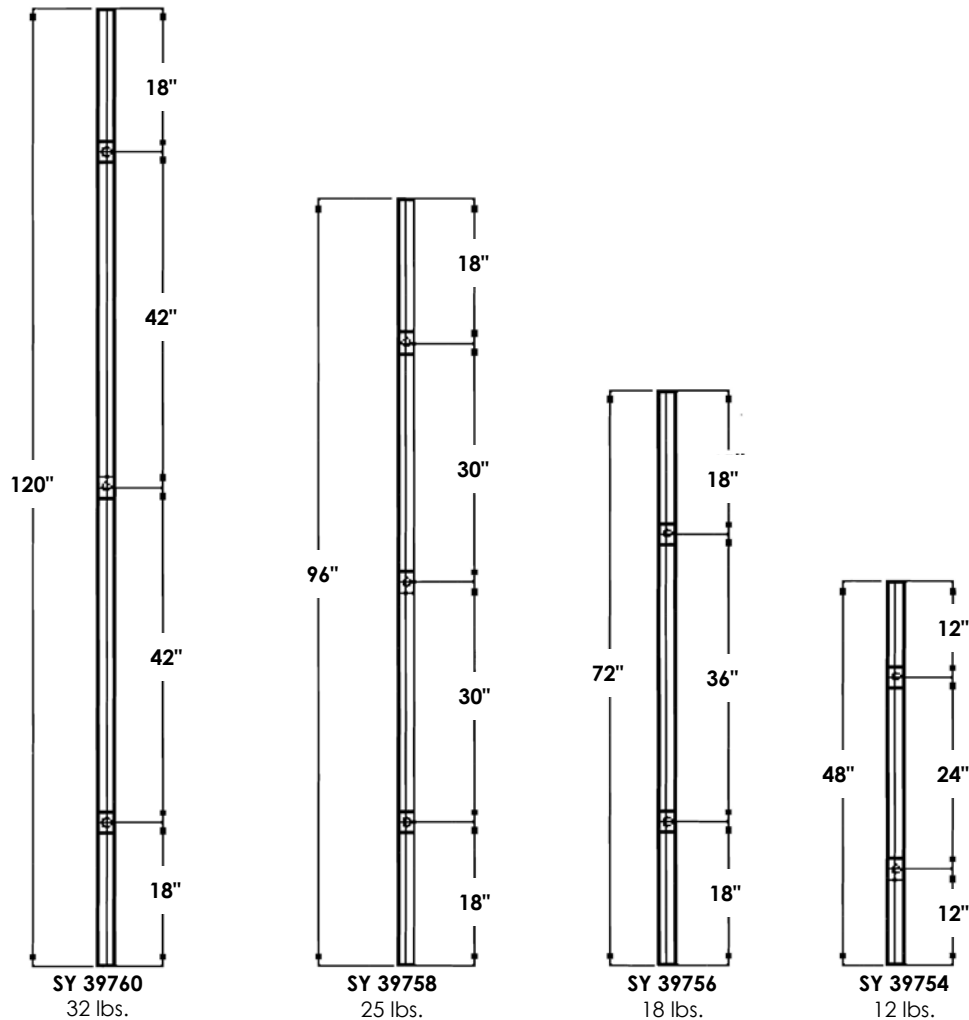

The Steel Ply Gang Filler is designed to increase productivity by reducing the number of ties required in conventional gangforming.

This 2" steel filler features preset tie hole locations in the face to accept 15 mm Taper Ties (3/4" to 5/8"), She Bolts or Tie Rods with 15 mm Tie Nuts to secure the tie.

The Steel Ply Gang Filler is placed between each Steel Ply panel and connected with a 3/4" x 4" flat coil bolt and nut (two connections are required per filler).

The Steel Ply Gang Filler is available in four lengths: 4', 6', 8', and 10'. Fillers can be stacked for gangs taller than 10'.

All standard accessories are compatible with the gang filler, including the Double-Duty Lift Bracket, the One-Piece Waler, Walkway Brackets and Turnbuckles.